



C45N 1P



C45N 2P



C45N 3P

C45N Series Mini Circuit Breaker

Application

C45N miniature circuit breaker is used in lighting distribution or motor distribution system for overload and short-circuit protection. It features pleasing out-look, light weight, reliable performance, high breaking capacity, and quick tripping function etc. Its frame and components adopt high fire-resistant and shockproof plastic for long-life use. It is mainly used for overload and short-circuit protection within the circuit of AC 50/60Hz, rated voltage of single pole up to 240V, two, three and four poles up to 415V. It can also be used for an unfrequent ON/OFF switching electric equipment and lighting circuit in normal case. The product complies with GB 10963, IEC 60898, VDE0641, and BS3871. And the product has three types: B type & C type for illumination and D type for industrial power.

Specifications

Number of Poles	1P, 2P, 3P, 4P	
Rated Current (A)	1, 2, 3, 4, 6, 10, 16, 20, 25, 32, 40	50, 63
Breaking Capacity (A)	6000	4500
Powe Factor	0.65~0.70	0.75~0.80
Rated Voltage (V)	240/415	
Rated Frequency	50/60Hz	
Circumstance Temperature	-5°C~+40°C	
Electrical Life	no less than 6000 operations	
Mechanical Life	(O-C) no less than 20000 operations	
Protection Degree	IP20	

Characteristic Curve

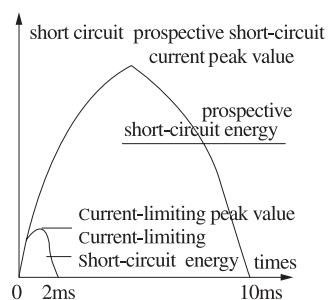
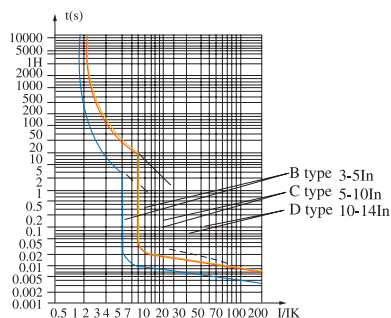

Dimensions

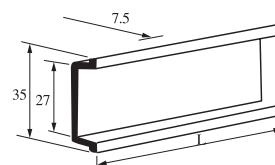
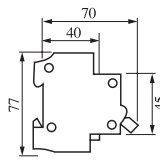
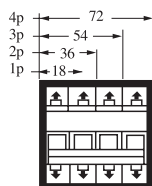



QGM98 Series Mini Circuit Breaker

Application

QGM98-63 miniature circuit breaker is used in lighting distribution or motor distribution system for overload and short-circuit protection. It features pleasing out-look, light weight, reliable performance, high breaking capacity, and quick tripping function etc. Its frame and components adopt high fire-resistant and shockproof plastic for long-life use. It is mainly used for overload and short-circuit protection within the circuit of AC 50/60Hz, rated voltage of single pole up to 240V, two, three and four poles up to 415V. It can also be used for an unfrequent ON/OFF switching electric equipment and lighting circuit in normal case. The product complies with GB 10963, IEC 60898, VDE0641, and BS3871. And the product has three types: B type & C type for illumination and D type for industrial power.

Specifications

Rated temperature of protective characteristics	40°C			
Rated voltage	240V/415V AC			
Rated current	1,3,5,10,20,25,32,40,50,60A			
Electric life	no less than 6000 times			
Mechanical life	no less than 20000 operations			
Test of damp&hot	II type (relative damp 95% at 55°C)			
Weight	1P	2P	3P	4P
	102	208	308	408



Performance

TYPE B,C,D

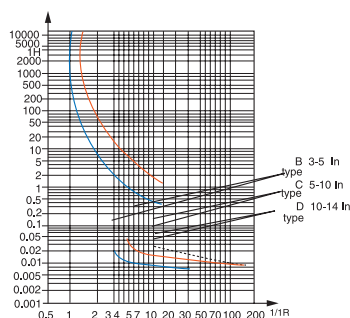

Dimensions

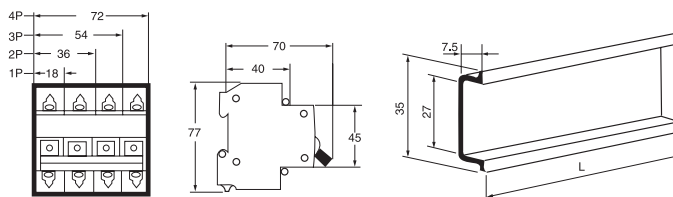



C65N 1P

C60N C65N Series Mini Circuit Breaker

Application

The series circuit breaker belongs to the advanced level of the nineties in the world instead of the old generation of C45N. They have protective functions against short circuit and overload, and are used in lighting distribution system in industry, commerce and dwelling, and protect fractional electric motors. They also have many merits of high breaking capacity, good reliability of sensitive action, convenient multi-pole assorting, long using life etc. They are mainly adapted to the circuit of AC 50/60Hz, 240V in single pole, 415V in double, three or four poles for protecting overload and short circuit. Meanwhile, they are also used in turning on or off the electric apparatus and lighting circuit under the normal condition. The products are produced according to IEC60898.

Specifications

Number of Poles	1P, 2P, 3P, 4P	
Rated Current (A)	1, 2, 3, 4, 6, 10, 16, 20, 25, 32, 40	50, 63
Breaking Capacity (A)	6000	4500
Rated Voltage (V)	240/415	
Rated Frequency	50/60Hz	
Circumstance Temperature	-5°C~+40°C	
Electrical Life	no less than 6000 operations	
Mechanical Life	(O-C) no less than 20000 operations	
Protection Degree	IP20	



C60N 2P

Characteristic Curve

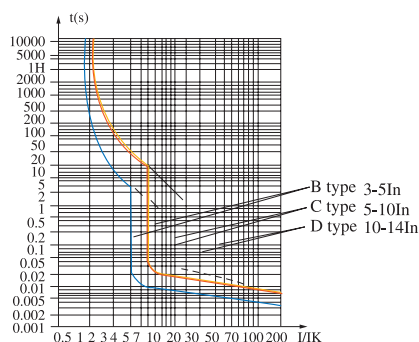

C60N 3P

Dimensions

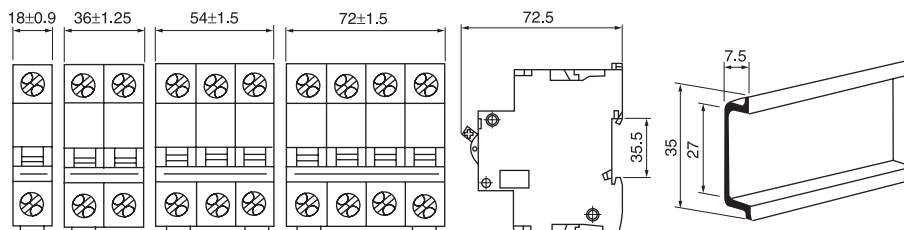



C30N 1P



C30N 2P



C30N 3P

C30N Series Mini Circuit Breaker

Application

C30N miniature circuit breaker is used in lighting distribution or motor distribution system for overload and short-circuit protection. It features pleasing out-look, light weight, reliable performance, high breaking capacity, and quick tripping function etc. Its frame and components adopt high fire-resistant and shockproof plastic for long-life use. It is mainly used for overload and short-circuit protection within the circuit of AC 50/60Hz, rated voltage of single pole up to 240V, two, three and four poles up to 415V. It can also be used for an unfrequent ON/OFF switching electric equipment and lighting circuit in normal case. The product complies with IEC 60898.

Specifications

Number of Poles	1P, 2P, 3P, 4P
Rated Current (A)	1, 2, 3, 4, 6, 10, 16, 20, 25, 32, 40, 50, 63
Breaking Capacity (A)	3000
Rated Voltage (V)	240/415
Rated Frequency	50/60Hz
Circumstance Temperature	-5°C~+40°C
Electrical Life	no less than 6000 operations
Mechanical Life	(O-C) no less than 20000 operations
Protection Degree	IP20

Characteristic Curve

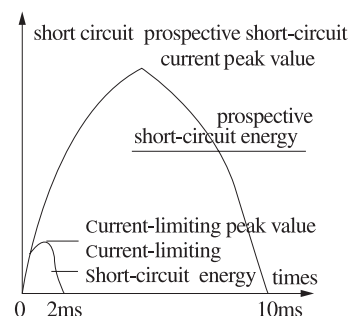
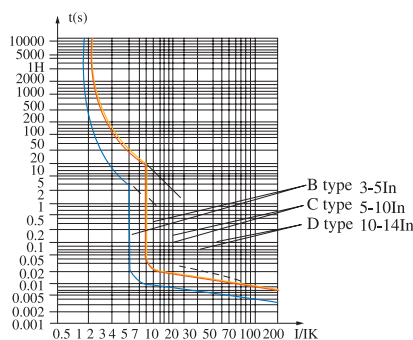

Dimensions

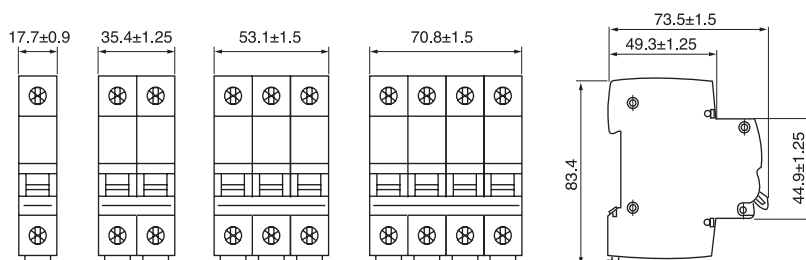



DZ30(DPN) Series Mini Circuit Breaker

Application

The product is applicable to protect line conductor and overload, and short circuit of small sealed motors. It is mainly for protection of circuits with AC 220V and 50Hz/60Hz, and for unfrequent conversion under normal conditions as well. Its action can be up to two pole with only one pole volume and be used as a leakage breaker by assembling with leakage. It is produced as per IEC 60898 standard.

Technical Data

Rated Current (A) (at 30°C)	1, 2, 3, 4, 6, 10, 16, 20, 25, 32
Rated Voltage (V)	220/240
Breaking capacity to IEC 60898	4500
Rated Frequency	50/60Hz
Number of operating cycles(O-C)	≥ 20000
Tripping characteristics	B 3-5I _n C 5-10I _n

Dimensions

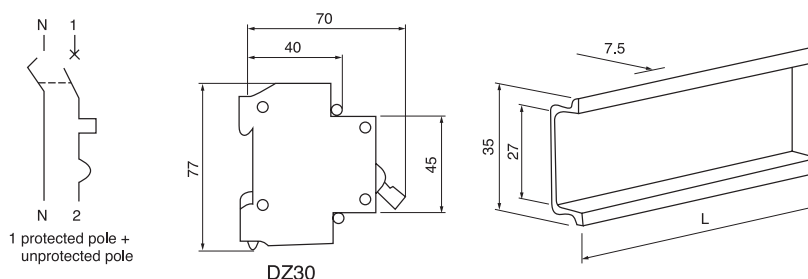

DS Series Mini Circuit Breaker

Main Technical data

Standard: IEC898, EN60898
Number of pole: 1, 2, 3
Rated voltage: 230/400V AC
Rated Current: 6, 10, 16, 20, 25, 32, 40, 50, 63A
Breaking Capacity: 6KA
Electrical endurance: 10.000 times
Protecting grade: IP20

Installation

On symmetrical DIN rail 35mm²
Panel mounting



NC100H 1P



NC100H 2P



NC100H 3P

NC-100H Series Mini Circuit Breaker

Application

NC100H high breaking capacity miniature circuit breaker is used for AC 50Hz or 60Hz, single pole 240V, 2,3,4 poles 415V for protecting the circuit that overload and short circuit may take place. It can be used in lighting and electric motor distribution system. Meantime, it is applicable to an unfrequent switch over the electric apparatus and lighting circuit under normal condition.

Specifications

Number of Poles	1P, 2P, 3P, 4P
Rated Current (A)	32, 40, 50, 63, 80, 100
Breaking Capacity (A)	IEC60947-10000
Rated Voltage (V)	240/415
Rated Frequency	50/60Hz
Circumstance Temperature	-5°C~+40°C
Electrical Life	no less than 6000 operations
Mechanical Life	(O-C) no less than 20000 operations
Protection Degree	IP20

Characteristic Curve

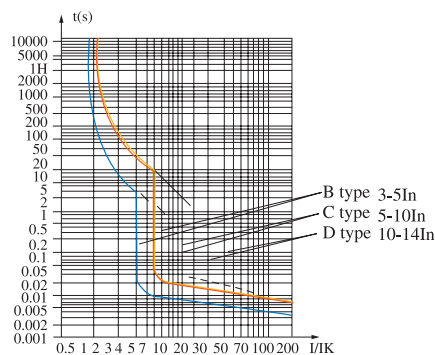

Dimensions

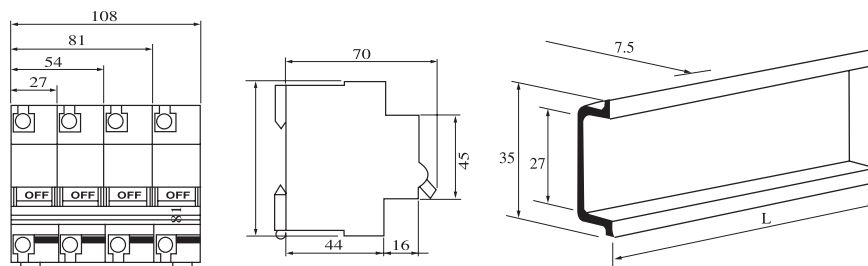



DX-63 1P



DX-63 2P



DX-63 3P

DX Series Mini Circuit Breaker

Application

DX miniature circuit breaker is mainly suitable for overload and short circuit protection. It is especially used for illumination and distribution in industry and commerce, etc. It has pleasing outlook & high breaking capacity, reliable performance, high inflammable resistance and shock resistance for long service life. It is to be used in the circuit of AC 50/60Hz, rated voltage of single pole up to 240V, two, three or four poles up to 415V. It can also be used for an unfrequent change over of the circuit and illumination under normal condition.

Specifications

Breaking Capacity (A)	6000
Rated Voltage (V)	240/415
Rated Current (A)	1, 3, 6, 10, 16, 20, 25, 32, 40, 50, 63
Standard	IEC 60898
Number of Poles	1P, 2P, 3P
Electrical Life (times)	8000
Mechanical Life (times)	20000

Characteristic Curve

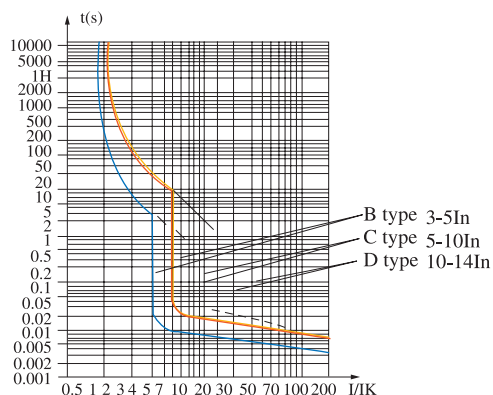

Dimensions

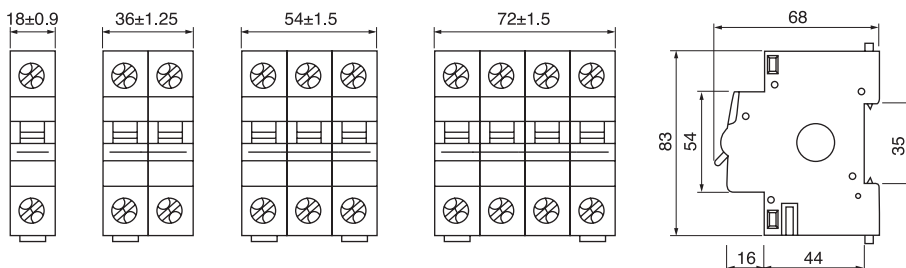



BKM Series Mini Circuit Breaker

Application

The design of the current-limiting device on the base increases the capability of circuit breaking up to a max. of 7.5KA(AC 220V).

The super-miniature and light product leaves the installation area minimum

The over current protection of bimetal sheet and the instantaneous and short-circuit protection featuring solenoid trip performs a perfect protection from current fault.

The DIN-Rail mounting method makes the installation easier.

Specifications

Type	B	C	D
Pole	1 2 3	1 2 3 4	1 2 3
Rated Voltage	240/415		
Rated Current	6,10,16,20,25	2,4,6,10,20,25,32,40,50	6,10,20,25,32,40,50
Breaking Capacity(KA)	10	6	6S
Tripping device	Thermal-coil magnetic		
Rated Frequency	50/60Hz		
Endurance	≥ 4000		
Circumstance Temperature	-5°C~+40°C		
Electrical Life	no less than 6000 operations		
Mechanical Life	(O-C) no less than 20000 operations		
Protection Degree	IP20		



BKN Series Mini Circuit Breaker

Application

BKN series circuit breaker is used in lighting distribution system or motor distribution system for protection overload and short-circuit in the system. The product is neoteric in structure, light in weight, reliable and excellent in performance. It has high breaking capacity, can trip quickly, and its case and items are adopted by high fire-resistant and shockproof plastics. The product, with long life, is mainly used in AC 50Hz/60Hz single pole 240V or two, three, four poles 415V circuit for overload and short-circuit protection as well as for unfrequent on-and-off switching electric equipment and lighting circuit in normal case. The products comply with IEC 60898.

Specifications

Number of Poles	1P, 2P, 3P, 4P
Rated Current (A)	2, 4, 6, 10, 16, 20, 25, 32, 40, 50, 63
Breaking Capacity (A)	6000
Rated Voltage (V)	240/415
Rated Frequency	50/60Hz
Endurance	≥ 4000
Circumstance Temperature	-5°C~+40°C
Electrical Life	no less than 6000 operations
Mechanical Life	(O-C) no less than 20000 operations
Protection Degree	IP20





L7 L8 Series Mini Circuit Breaker

Application

L7 and L8 series circuit breaker are used in lighting distribution system or motor distribution system for protection overload and short-circuit in the system. The product is neoteric in structure, light in weight, reliable and excellent in performance. It has high breaking capacity, can trip quickly, and its case and items are adopted by high fire-resistant and shockproof plastics. The product, with long life, is mainly used in AC 50Hz/60Hz single pole 240V or two, three, four poles 415V circuit for overload and short-circuit protection as well as for unfrequent on-and-off switching electric equipment and lighting circuit in normal case. The products comply with IEC 60898.

Specifications

Number of Poles	1P, 2P, 3P, 4P
Rated Current (A)	2, 4, 6, 10, 16, 20, 25, 32, 40, 50, 63
Rated Voltage (V)	240/415V; 50/60Hz
Rated Breaking Capacity (A)	10000A IEC898 15000A IEC947-2
Short Circuit Breaking Capacity of DC	Max. 48V(L7-DC, 10KA)single pole Max. 250V(L7-DC, 6KA)single pole
Performance	C, D characteristic curve
Max.fuse That Can be Connected to	100AgL(>10KA)
Selective Grade	3
Working Ambient Temperature	-5~+40°C
Enclosed Protective Class	IP40(Under mounting)
Electrical Life	not less than 8000 times operation
Mechanical Life	not less than 20000 times operation



Dimensions of L7 Miniature Circuit Breaker

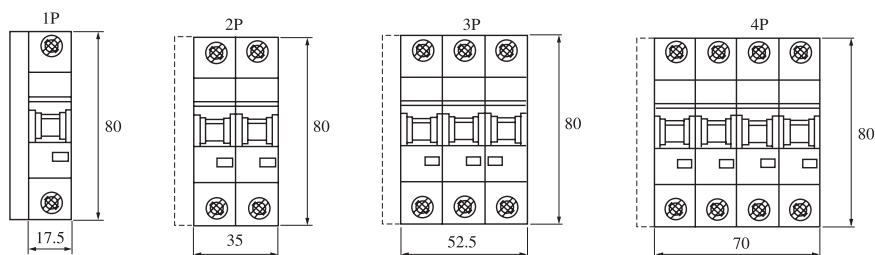

Dimensions of L8 Miniature Circuit Breaker

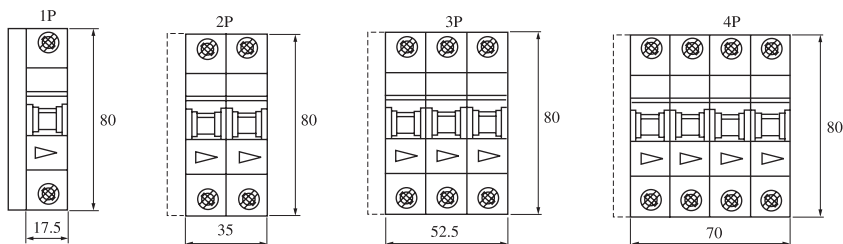



BH-D6 Series Mini Circuit Breaker

Application

Products of domestic power distribution box have come out. The high-quality and high function circuit breaker used in domestic power distribution box is looking forward to your selection and application.

Function

1. All the machines meet the standard of IEC and GB.
2. They can be installed in the track of 35mm of IEC.
3. They have the function of high current limit.
4. Protective grade: IP2x

Specifications

Standard	GB10963, IEC60898
Rated Voltage	240/415VAC, 50/60Hz
Rated current	6, 10, 13, 16, 20, 25, 32, 40, 50, 63A
Ambient temperature	-10°C~40°C
Inst trip current	B, C, D
Rated short-circuit interrupting capacity	6KA
Rated running short-circuit interrupting capacity	6KA
Mechanical life	8000
Electrical life	8000
Mtg	track of 35mm of IEC
terminal(the side of ON)	non-weld tin terminal
terminal(the side of OFF)	non-weld tin terminal/terminal with mouth
Bus.t	0.7-1.5mm
Applied wire	1-25mm ²
releasing method of overload	Thermal-coil magnetic
Accessories	Insulation board



Dimension

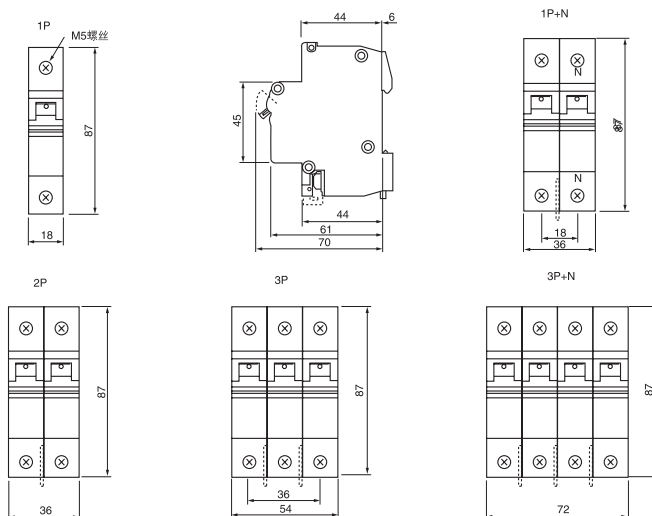



MT MY MU Series Mini Circuit Breaker

Application

MT MY MU miniature circuit breaker is mainly suitable for overload and short circuit protection. It is especially used for illumination and distribution in industry and commerce. It is of pleasing outlook & high breaking capacity etc. Its frame and parts adopt plastics of light weight, reliable performance, high inflammable resistance and shock resistance for long service life. It is mainly used for overload and short circuit protection within the circuit of AC 50/60Hz, rated voltage of single pole up to 240V, two, three or four poles up to 415V. It can also be used for an unfrequent switchover of the circuit and illumination under normal conditions.

Specifications

Number of Poles	1P, 2P, 3P, 4P	
Rated Current (A)	1, 2, 3, 4, 6, 10, 16, 20, 25, 32, 40	50, 63
Breaking Capacity (A)	6000	4500
Rated Voltage (V)	240/415	
Rated Frequency	50/60Hz	
Circumstance Temperature	-5°C~+40°C	
Electrical Life	no less than 6000 operations	
Mechanical Life	(O-C) no less than 20000 operations	
Protection Degree	IP20	



Characteristic Curve

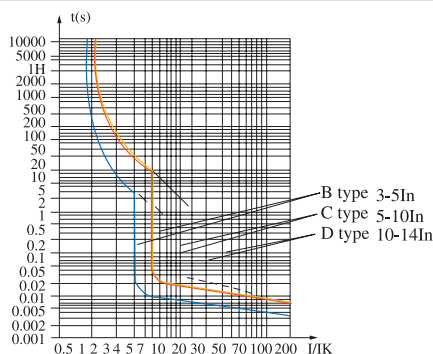

Dimensions

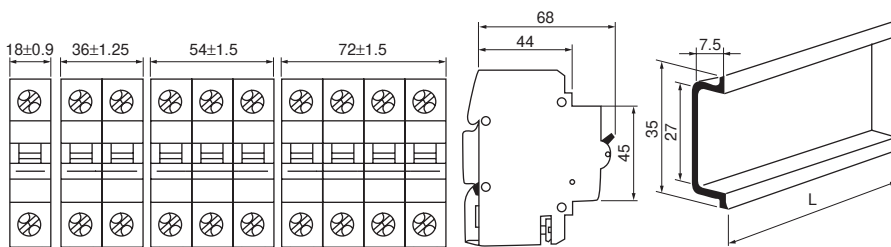



MBL Series Mini Circuit Breaker

Application

MBL series circuit breaker is used in lighting distribution system or motor distribution system for protection overload and short-circuit in the system. The product is neoteric in structure, light in weight, reliable and excellent in performance. It has high breaking capacity, can trip quickly, and its case and items are adopted by high fire-resistant and shockproof plastics. The product, with long life, is mainly used in AC 50Hz/60Hz single-pole 240V or two, three, four-pole 415V circuit for overload and short-circuit protection as well as for unfrequent on-and-off switching electric equipment and lighting circuit in normal case. The products comply with IEC 60898.

Specifications

Number of Poles	1P, 2P, 3P	
Rated Current (A)	1, 2, 4, 6, 8, 10, 13, 16, 20, 25, 32, 40	50, 63
Breaking Capacity (kA)	6000	4500
Rated Voltage (V)	240/415	
Rated Frequency	50/60Hz	
Endurance	≥ 4000	
Circumstance Temperature	-5°C~+40°C	
Electrical Life	no less than 6000 operations	
Mechanical Life	(O-C) no less than 20000 operations	
Protection Degree	IP20	



K Series Mini Circuit Breaker

Application

K series miniature circuit breaker is mainly suitable for overload and short circuit protection. It is especially used for illumination and distribution in industry and commerce. It is of pleasing out-look, light weight, reliable performance, high breaking capacity, etc. Its frame and parts adopt plastics of high inflammable resistance and shock resistance for long service life. It is mainly used for overload and short circuit protection within the circuit of AC 50/60 Hz, rated voltage of single pole up to 240V, two, three or four poles up to 415V. It can also be used for an unfrequent switchover of the circuit and illumination under normal conditions.

Specifications

Number of Poles	1P, 2P, 3P
Rated current (A)	2, 4, 6, 10, 16, 20, 25, 32, 40, 50, 63
Rated voltage (V)	240/415
Frequency	50/60Hz
Rated breaking capacity (A)	3000





E91 S91 Series Mini Circuit Breaker

Application

E91 S91 series circuit breaker is used in lighting distribution system or motor distribution system for protection overload and short-circuit in the system. The product is neoteris in structure, light in weight, reliable and excellent in performance. It has high breaking capacity, can trip quickly, and its case and items are adopted by high fire-resistant and shockproof plastics. The product, with long life, is mainly used in AC 50Hz/60Hz single pole 240V or two, three, four pole 415V circuit for overload and short-circuit protection as well as for unfrequent on-and-off switching electric equipment and lighting circuit in normal case. The products comply with IEC 60898.

Specifications

Number of Poles	1P, 2P, 3P, 4P	
Rated Current (A)	1, 2, 3, 4, 6, 10, 16, 20, 25, 32, 40	50, 63
Breaking Capacity (kA)	6000	4500
Rated Voltage (V)	240/415	
Rated Frequency	50/60Hz	
Endurance	≥ 4000	
Circumstance Temperature	-5°C~+40°C	
Electrical Life	no less than 6000 operations	
Mechanical Life	(O-C) no less than 20000 operations	
Protection Degree	IP20	



Characteristic Curve

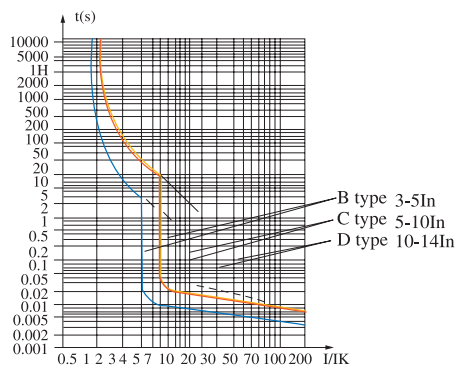

Dimensions

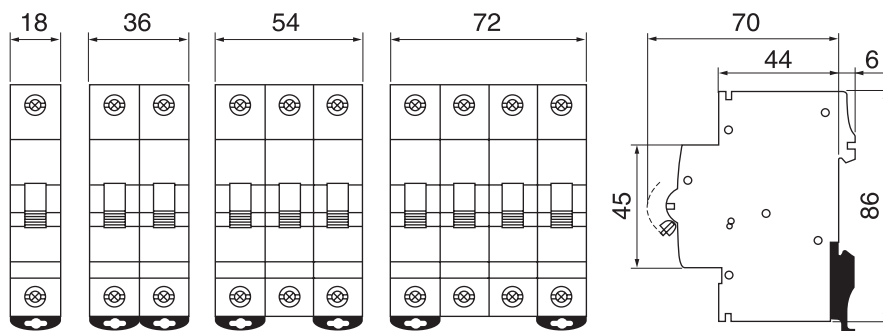



H6 Series Mini Circuit Breaker

Application

H6 miniature circuit breaker can be used in the building office, house, industry and similar building for illuminating in AC 50/60Hz, rated voltage below 415V, rated current 63A, circuit for overload and short-circuit protection as well as for unfrequent on-and-off switching electric equipment and lighting circuit in normal case. The products comply with IEC 60898.

Specifications

Pole Number	Rated Current (A)	Rated Voltage (V)	Maximum Breaking Capacity	Electrical Life (times)	Mechanical Life (times)
1	6,10,16,20,25,32,40,50,63	240/415	6000A	6000	20000
2		415			
3					



S101 Series Screw Type Circuit Breaker

Application

The circuit breakers are suitable used in AC and DC 32A and below electric circuits of 50/60Hz, up to 380V and up to DC 250V respectively, for protection of electrical circuits and apparatus in office and residence buildings, and for protection of circuit terminals against overload and short circuit. The item is a durable protection that substitutes the traditional fuse element and can be used in each fuse socket with E27 thread according to DIN 40440.

Specifications

Pole Number	Single Pole	Single Pole
Rated Current (A)	2-25	32
Rated Voltage (V)	250/380	250/380
Breaking Capacity (A)	3000	3000
Power Factor for Testing Circuit (A)	0.65-0.70	0.75-0.80

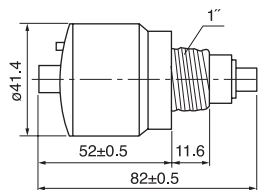

Note: The connecting thread of the circuit breaker is "1"



S230-1P

S230 S250 Mini Circuit Breaker

Application

This protective-conductor mini circuit breaker has features of new structure, excellent performance, easy installation, high breaking capacity. It is mainly used for overload and short circuit protection of AC 50Hz or 60Hz, rated voltage of single pole up to 240V, rated current up to 60A and in distribution of illumination of industry, commerce and buildings.

Specifications

Accord with standards: IEC364, SSCP5, IEE

Rated current (A)	Pole number (P)	Rated voltage (V)	Rated Frequency (Hz)	Breaking capacity (A)
2,4,6,10,16, 20,25,32,40, 50,63	1P	240V	50/60Hz	3000A/6000A
	2P,3P	415V		



S250-2P

Dimensions(mm)

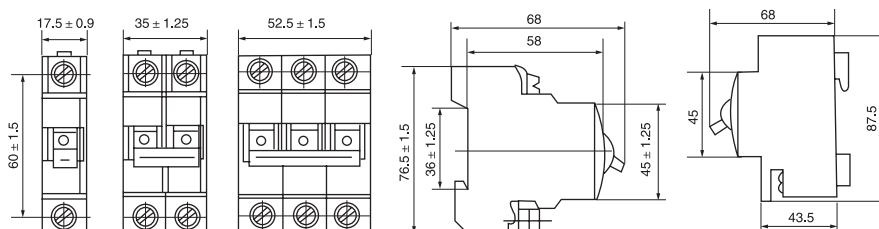

CBT-1P

CBT Circuit Breaker

Extensive modular system provides overcurrent, short circuit protection

Single and multipole MCB's employing a magnetic-hydraulic operation principle, ideally suitable for use over a wide range of operating temperatures.

Short circuit duty rating: 4.5KA 240/415V 50/60HZ, confirming to BS3871.

Nominal operating temperature range: -0°C to 60°C

No derating factors needed when mounting breakers side by side in enclosed cabinets



CBT-3P



Rus Circuit Breaker

Application

Rus type circuit breaker has small size ,light weight,novel structure and excellent performance. They are mostly used in the illuminating distribution board and guesthouses, block of flats,high buildings,square,airports,railway station,plants and enterprises etc in for protecting from overload and short circuit in the circuit .



200BZ 200B Overload Protection Switch

Application

200BZ,200B overload protection switch is suitable for AC 230/400V electrical control system.It is the advanced switch in domestic or precision apparatus.

Specifications

Rated Current	3,5,10,15,20A
Rated Voltage	AC230/400V
Rated frequency	50Hz/60Hz
Mechanical life	10000 times
Electrical life	6000 times



N45 Turnover Switch

Application

N45 turnover switch is used as a main switch in the circuit of AC 230V/16A for both terminal assembly electric equipment case and illumination assembly case. It can control various motors and other small power electric equipment, but it don't have the function of overload and short-circuit protection.





THQL1-1P

THQL1' Miniature Circuit Breaker

Application

THQL1' miniature circuit breaker applies to industrial, commercial, lighting and electric machine distribution system with AC415V, 50/60Hz, rated working current up to 100A to protect against overload and short circuit. The item is installed into plug-in type mounting base.

Specifications

Number of Poles	1P, 2P, 3P
Rated Current (A)	6, 10, 15, 20, 25, 30, 40, 50, 60, 70, 80, 90, 100
Rated Voltage (V)	110/220 (1P), 240/415 (2P), 415 (3P)
Breaking Capacity (A)	3000
Electrical Life (Times)	6000
Mechanical Life (Times)	20000



THQL-3P



THQL 1/2 1P

THQL1/2' Miniature Circuit Breaker

Application

THQL1/2' miniature circuit breaker applies to industrial, commercial, lighting and electric machine distribution system with AC415V, 50/60Hz, rated working current up to 100A to protect against overload and short circuit. The item is installed into plug-in type mounting base.

Specifications

Number of Poles	1P, 2P, 3P
Rated Current (A)	6, 10, 15, 20, 25, 30, 40, 50, 60, 70, 80, 90, 100
Rated Voltage (V)	110/220 (1P), 240/415 (2P), 415 (3P)
Breaking Capacity (A)	3000
Electrical Life (Times)	6000
Mechanical Life (Times)	20000



THQL 1/2 2P



BH 1P



BH 3P



BH-P 1P



BH-P 3P

BH Miniature Circuit Breaker

Application

BH series miniature circuit breaker is characteristic of small size, light weight, novel structure and excellent performance. They are mounted in the illuminating distribution board and used in guesthouses, block of flats, high buildings, squares, airports, railway stations, plants and enterprises etc, in AC circuits 240V (single pole) up to 415V (3 pole) 50Hz for protection of overload short circuit and for circuit change-over in lighting system. Breaking capacity is 3KA. The items comply with IEC60898 standard.

Specifications

Number of Poles	1P, 2P, 3P
Rated Current (A)	6, 10, 16, 20, 25, 30, 40, 50, 63, 70, 80, 90, 100
Rated Voltage (V)	110/220 (1P), 240/415 (2P), 415 (3P)
Breaking Capacity (A)	3000
Electrical Life (Times)	6000
Mechanical Life (Times)	16000

Dimensions

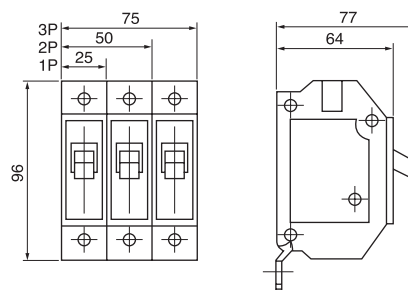

BH-P Miniature Circuit Breaker

Application

BH-P miniature circuit breaker applies to industrial, commercial, lighting and electric machine distribution system with AC415V, 50/60Hz, rated working current up to 100A to protect against overload and short circuit. The item is installed into plug-in type mounting base.

Specifications

Number of Poles	1P, 2P, 3P
Rated Current (A)	6, 10, 16, 20, 25, 30, 40, 50, 63, 70, 80, 90, 100
Rated Voltage (V)	110/220 (1P), 240/415 (2P), 415 (3P)
Breaking Capacity (A)	3000
Electrical Life (Times)	6000
Mechanical Life (Times)	16000

Other Products



MN1

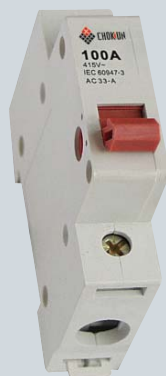

HL-100 1P



HL-100 2P



HL-100 3P



KD



SB-140



SB-240



SB-340



E81



H7-1P



H7-2P



H7-3P

Other Products

